

Step 1.

Using the template provided, mark cutouts along crack approximately every 12 inches, alternating between large and small template. Then using a pencil, mark the circles for the holes to be drilled on either side of crack.

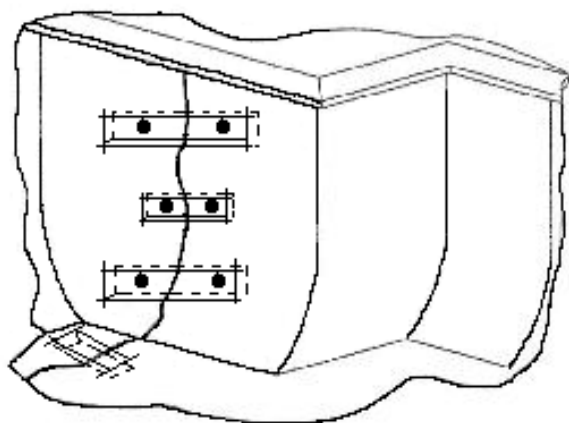
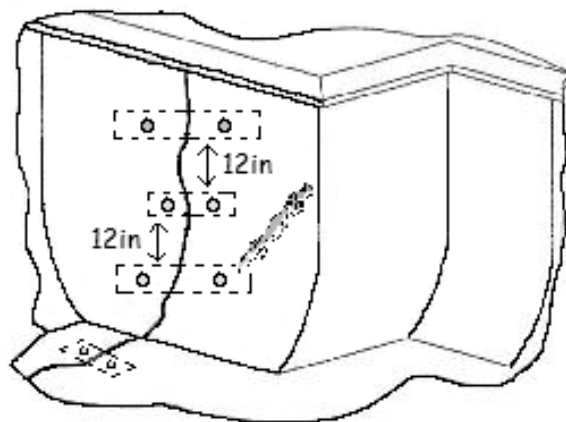

Step 2.

Using a masonry saw, cut into structure along marked lines approximately 2 inches deep. On drill markings, drill into structure a minimum of 6 inches deep using a 3/4 inch masonry bit.

NOTE: If you should drill deeper than the recommended depth as described above, this will have no effect on the performance of the Torque Lock Staple.

Step 3.

Using the epoxy provided, apply to the reinforcement pins as shown.

Then, assemble unit and with both hands, slide pins into pre-drilled holes.

Then push the Torque Lock unit back until the locking plate is recessed approximately 2 inches into the wall.

NOTE: DO NOT GET EPOXY ON THE CAMS OR LOCKING PLATE!!

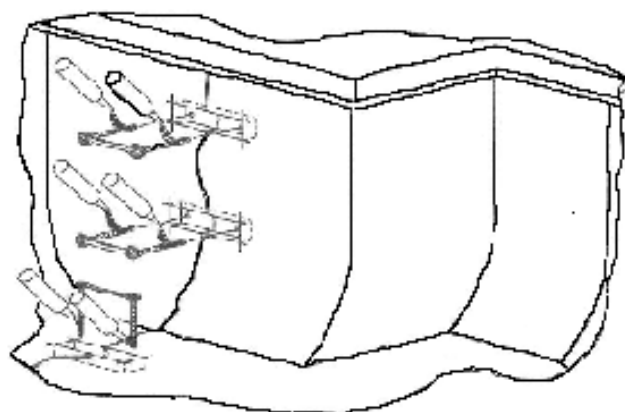

IMPORTANT:

MAKE SURE TOOLING HOLES ARE FACING EACH OTHER WHEN SETTING STAPLES AS SHOWN BELOW

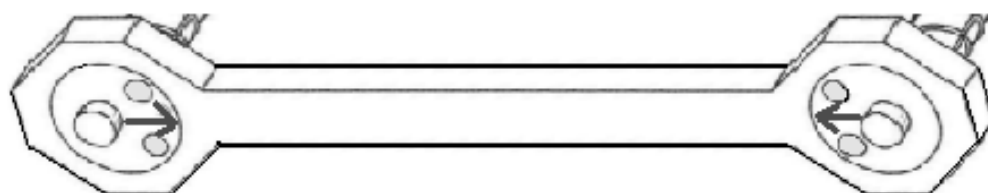

Step 4.

Using a torque wrench and a 1/2 inch socket, insert torque tool on the right side and tighten clockwise 180 degrees until 40lbs of pull torque is reached.

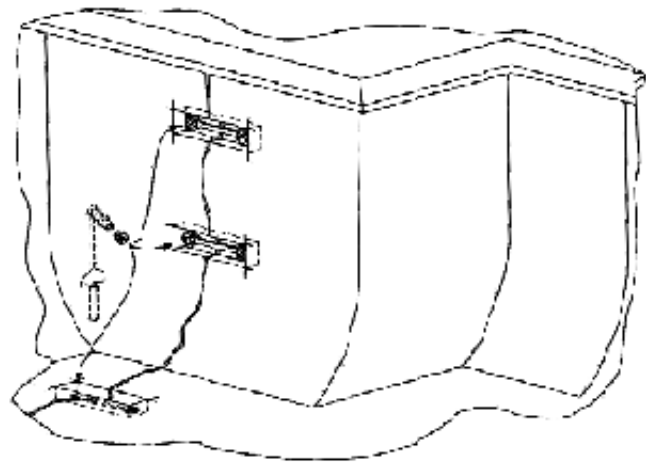
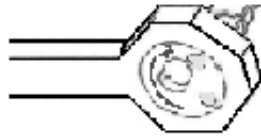

*****IMPORTANT*****

DO NOT TIGHTEN ABOVE 40 lbs TORQUE PRESSURE BETWEEN BOTH PINS.

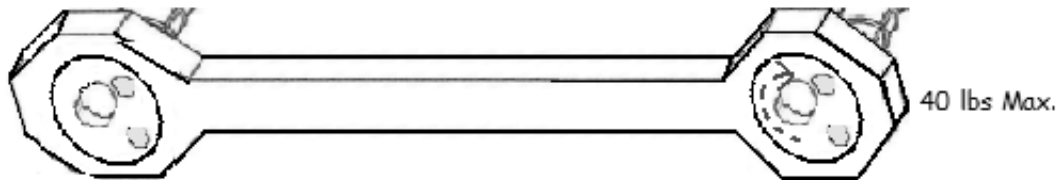

IF MAXIMUM PRESSURE OF 40lbs IS REACHED UPON TURNING FIRST CAM 180 DEGREES OR LESS, IT IS NOT NECESSARY TO TURN THE OTHER.

*****DO NOT TURN EITHER CAM MORE THAN 180 DEGREES.**

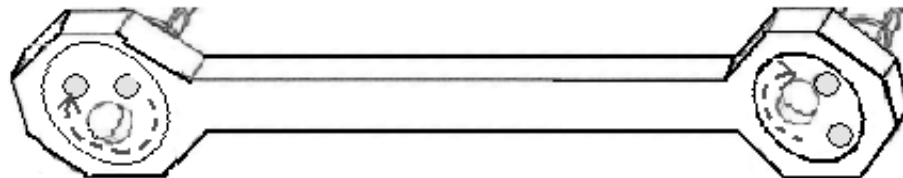

INCORRECT
270 Degree turn shown above

CORRECT
180 Degree turn shown above

Step 5.

Using a diamond or carbide blade, "V" open crack between cut outs. Be sure to clean out crack & cut outs of all dust & debris

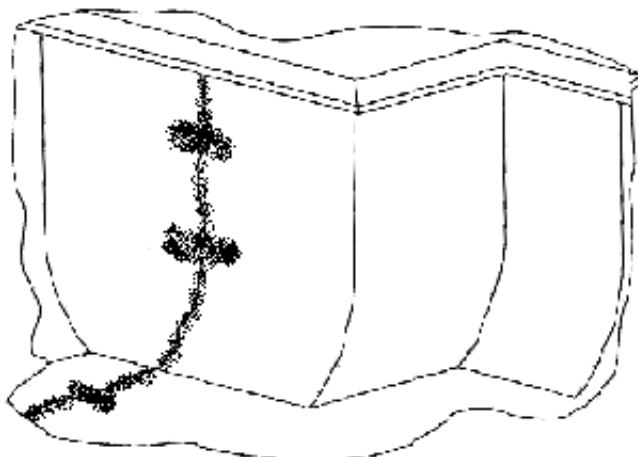

Step 6.

Using a non shrinking cement (hydraulic cement) fill in crack & cut outs. Use a trowel to pack in cement tightly making sure you leave no voids.

After finishing this process, you can go over the repaired area(s) with with any finishing product you would like to use (plaster, paint, tile, marcite, cool deck etc.)